

Архангельск (8182)63-90-72
 Астана (7172)727-132
 Астрахань (8512)99-46-04
 Барнаул (3852)73-04-60
 Белгород (4722)40-23-64
 Брянск (4832)59-03-52
 Владивосток (423)249-28-31
 Волгоград (844)278-03-48
 Вологда (8172)26-41-59
 Воронеж (473)204-51-73
 Екатеринбург (343)384-55-89
 Иваново (4932)77-34-06

Ижевск (3412)26-03-58
 Иркутск (395)279-98-46
 Казань (843)206-01-48
 Калининград (4012)72-03-81
 Калуга (4842)92-23-67
 Кемерово (3842)65-04-62
 Киров (8332)68-02-04
 Краснодар (861)203-40-90
 Красноярск (391)204-63-61
 Курск (4712)77-13-04
 Липецк (4742)52-20-81
 Киргизия (996)312-96-26-47

Магнитогорск (3519)55-03-13
 Москва (495)268-04-70
 Мурманск (8152)59-64-93
 Набережные Челны (8552)20-53-41
 Нижний Новгород (831)429-08-12
 Новокузнецк (3843)20-46-81
 Новосибирск (383)227-86-73
 Омск (3812)21-46-40
 Орел (4862)44-53-42
 Оренбург (3532)37-68-04
 Пенза (8412)22-31-16
 Россия (495)268-04-70

Пермь (342)205-81-47
 Ростов-на-Дону (863)308-18-15
 Рязань (4912)46-61-64
 Самара (846)206-03-16
 Санкт-Петербург (812)309-46-40
 Саратов (845)249-38-78
 Севастополь (8692)22-31-93
 Симферополь (3652)67-13-56
 Смоленск (4812)29-41-54
 Сочи (862)225-72-31
 Ставрополь (8652)20-65-13
 Казахстан (772)734-952-31

Сургут (3462)77-98-35
 Тверь (4822)63-31-35
 Томск (3822)98-41-53
 Тула (4872)74-02-29
 Тюмень (3452)66-21-18
 Ульяновск (8422)24-23-59
 Уфа (347)229-48-12
 Хабаровск (4212)92-98-04
 Челябинск (351)202-03-61
 Череповец (8202)49-02-64
 Ярославль (4852)69-52-93

<https://chint.nt-rt.ru> || cfg@nt-rt.ru

Реле времени серии JSZ3

Relay Control Relay



JSZ3 Time Delay Relay

1. General

JSZ3 Time Delay Relay is applicable for automatic control system, such as machine automatic control, and complete equipment automatic control, etc.

2. Type designation

JS Z 3 □ - □

Adopt A, B, C, D, E, F, G to represent delay rang code (applicable for multi-range type)

- A: basic type (power on delay, multi-range type)
- C: instantaneously operation type (power on delay, multi-range type)
- F: power off delay type
- Y: delta start-delay type (power on delay)
- K: control off-delay
- R: repeat circulation-delay type (power on delay)

Design sequence No.

Integrative type

Time Delay Relay

3. Technical data

Type	JSZ3A	JSZ3C	JSZ3F	JSZ3K	JSZ3Y	JSZ3R
Operating mode	power on delay	JSZ3C power on delay with instantaneously operation contact	power off delay	Signal breaking-delay	Delta start-delay	Reciprocating circulation-delay
Delay range	A: (0.05-0.5)s/5s/30s/3min		(0.1-1)s	(0.1-1)s	(0.1-1)s	(0.5-6)s/60s
	B: (0.1-1)s/10s/60s/6min		(0.5-5)s	(0.5-5)s	(0.5-5)s	(1-10)s/10min
	C: (0.5-5)s/50s/5min/30min		(1-10)s	(1-10)s	(1-10)s	(2.5-30)s/30min
	D:(1-10)s/100s/10min/60min		(2.5-30)s	(2.5-30)s	(2.5-30)s	(5-60)s/60min
	E: (5-60)s/10min/60min/6h		(5-60)s	(5-60)s	(5-60)s	
	F:(0.25-2)min/2min/2h/12h		(10-180)s	(10-180)s	(10-180)s	
	G:(0.5-4)min/40min/4h/24h					
Set mode	Potentiometer					
Operating voltage	AC50Hz/60Hz, 36V, 110V, 127V, AC220V AC230V AC380V AC400V DC24V	AC50Hz/60Hz, 36V, 110V, 127V AC220V AC230V AC380V AC400V DC24V	AC50Hz/60Hz AC110V AC220V AC230V AC380V AC400V DC24V	AC36V,AC110V 50Hz/60Hz AC220V AC230V AC380V AC400V DC24V	AC36V,AC110V 50Hz/60Hz AC220V AC230V AC380V AC400V DC24V	AC36V,AC110V 50Hz/60Hz AC220V AC230V AC380V AC400V DC24V
Delay precision	≤10%					
Contact number	Delay 2 switching, delay 1 changeover, instantaneous switching		Delay 1 switching or delay 2 switching	Delay 1 switching	Delay Delta 1 switching	Delay 1 switching
Contact capacity	Ue/Ie: AC-15 220V/0.75A, 380V/0.47A; DC-13 220V/0.27A;Ith:5A					
Electrical Endurance	1 × 10 ⁵					
Mechanical Endurance	1 × 10 ⁶					
Ambient temperature	-5℃ ~ +40℃					
Installation mode	Panel type, Equipment type					
Matched pedestal	Panel type: FM8858, CZS08S, Equipment type,CZS08X-E					

4. Wiring diagram

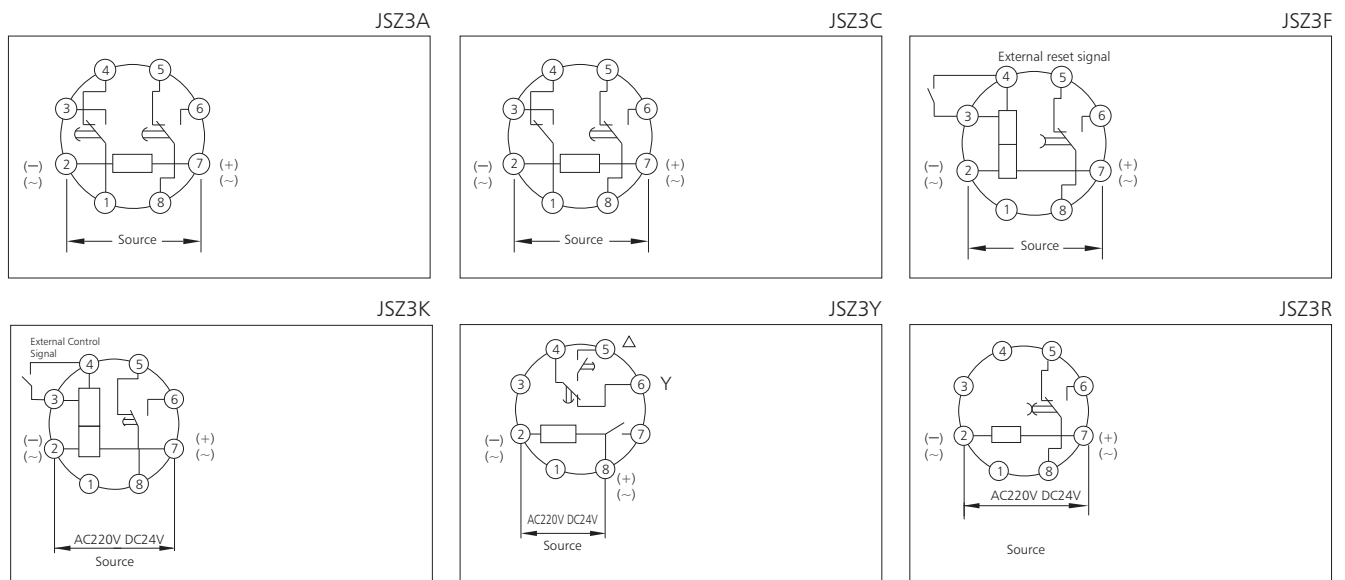

Relay

Control Relay

5. Overall and mounting dimensions (mm)

JSZ3A-,C-, F, K, Y Profile and installation dimension

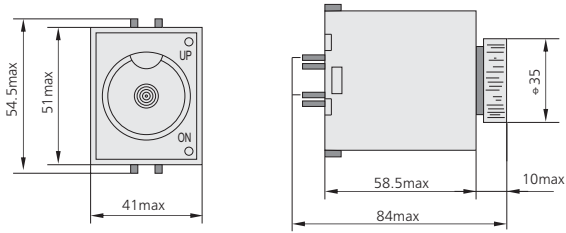

JSZ3R Profile and installation dimension

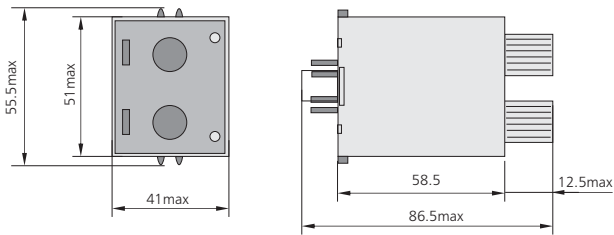

Opening size

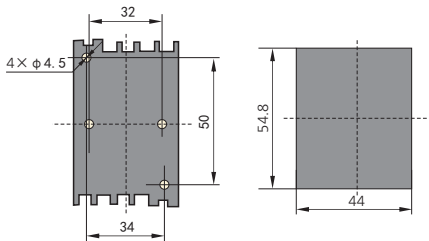

Архангельск (8182)63-90-72
Астана (7172)727-132
Астрахань (8512)99-46-04
Барнаул (3852)73-04-60
Белгород (4722)40-23-64
Брянск (4832)59-03-52
Владивосток (423)249-28-31
Волгоград (844)278-03-48
Вологда (8172)26-41-59
Воронеж (473)204-51-73
Екатеринбург (343)384-55-89
Иваново (4932)77-34-06

Ижевск (3412)26-03-58
Иркутск (395)279-98-46
Казань (843)206-01-48
Калининград (4012)72-03-81
Калуга (4842)92-23-67
Кемерово (3842)65-04-62
Киров (8332)68-02-04
Краснодар (861)203-40-90
Красноярск (391)204-63-61
Курск (4712)77-13-04
Липецк (4742)52-20-81

Киргизия (996)312-96-26-47

Магнитогорск (3519)55-03-13
Москва (495)268-04-70
Мурманск (8152)59-64-93
Набережные Челны (8552)20-53-41
Нижний Новгород (831)429-08-12
Новокузнецк (3843)20-46-81
Новосибирск (383)227-86-73
Омск (3812)21-46-40
Орел (4862)44-53-42
Оренбург (3532)37-68-04
Пенза (8412)22-31-16

Россия (495)268-04-70

Пермь (342)205-81-47
Ростов-на-Дону (863)308-18-15
Рязань (4912)46-61-64
Самара (846)206-03-16
Санкт-Петербург (812)309-46-40
Саратов (845)249-38-78
Севастополь (8692)22-31-93
Симферополь (3652)67-13-56
Смоленск (4812)29-41-54
Сочи (862)225-72-31
Ставрополь (8652)20-65-13

Казахстан (772)734-952-31

Сургут (3462)77-98-35
Тверь (4822)63-31-35
Томск (3822)98-41-53
Тула (4872)74-02-29
Тюмень (3452)66-21-18
Ульяновск (8422)24-23-59
Уфа (347)229-48-12
Хабаровск (4212)92-98-04
Челябинск (351)202-03-61
Череповец (8202)49-02-64
Ярославль (4852)69-52-93